



# FOR LEASE

±2,500-8,200 SF Medical Office  
At Presbyterian Hospital Rockwall  
3136 Horizon Rd Rockwall, TX



- ±2,500-8,200 SF Available
- Generous Tenant Improvement Allowance
- Individual Exterior Entrances
- Tenant-Controlled Space
- No Common Area Factor
- Directly in Front of Presbyterian Hospital Rockwall
- Great Horizon Road Frontage & Access
- Tenant: Lake Pointe Orthopaedics
- Insulated Panel Construction for Energy Efficiency

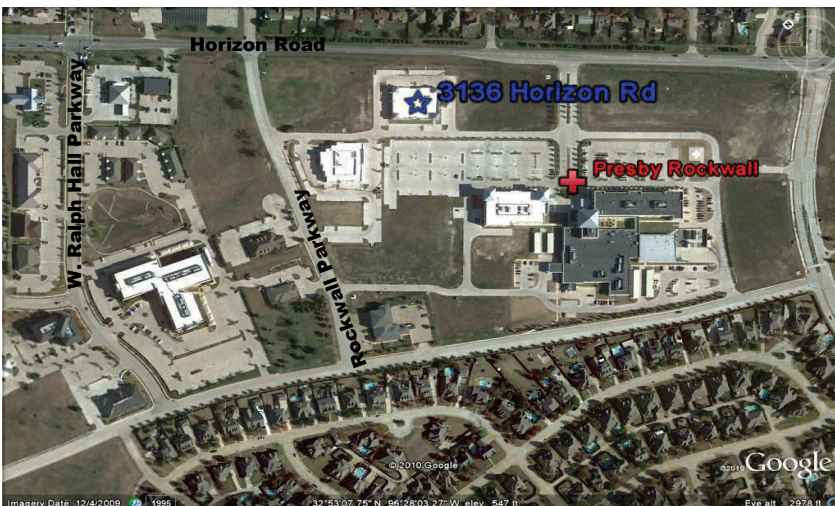

Scott Asbury

214.922.9797

SAsbury@3LRealtyGroup.com





Horizon Road

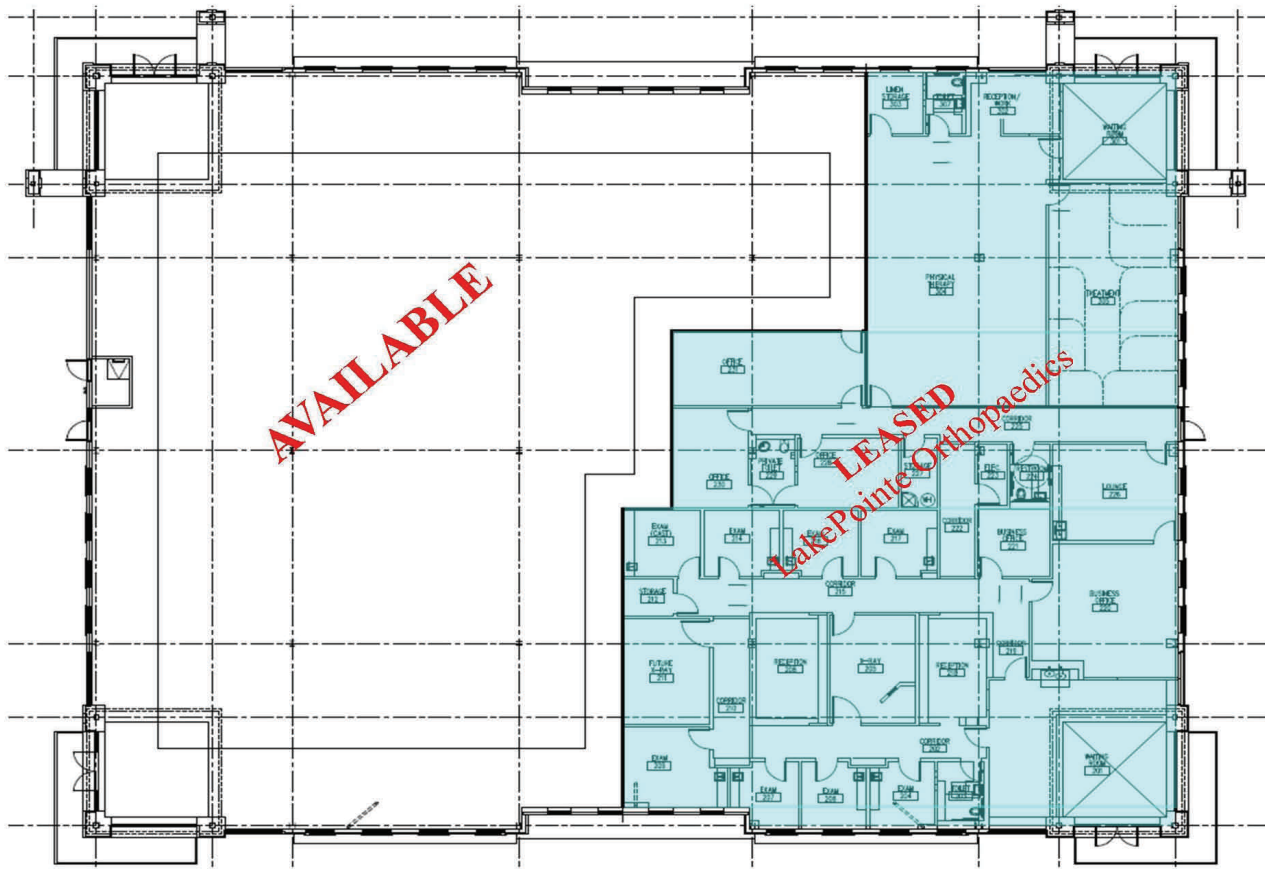

Presbyterian Hospital of Rockwall